

15cc SE

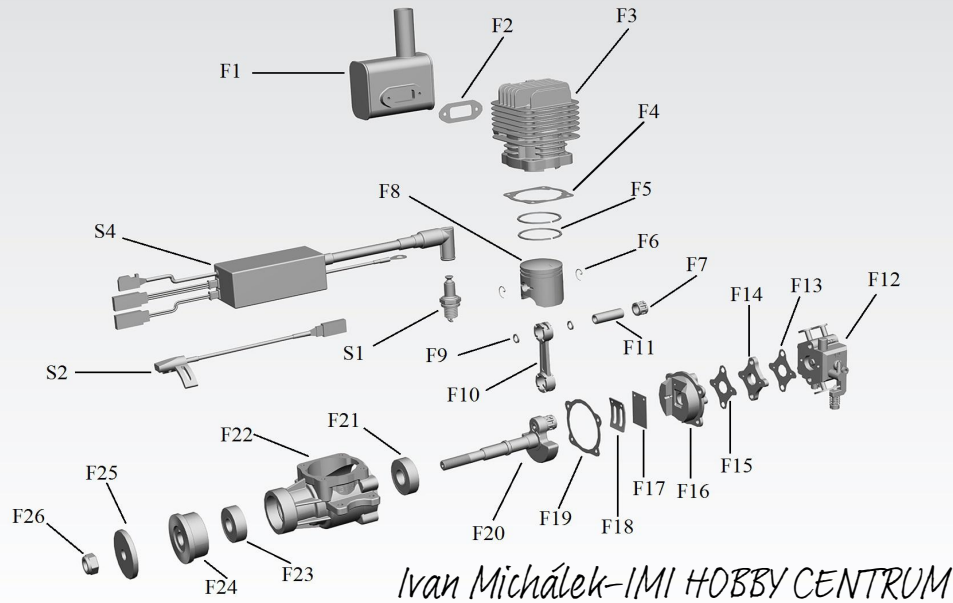

Stinger 15cc SE *Ivan Michálek-IMI HOBBY CENTRUM*

Parameter:

Type : 2 cycle piston valve type gasoline engine for airplane

Piston displacement Cylinder (cc) : 15cc (.91 cu in)

Bore x Stroke (mm): 1.3 in(32mm) x 0.8 in (19.6mm)

Carburetor : Walbro

Ignition : DC-CDI (Computer Controlled auto advance, electronic ignition system)

Power supply: 6-14V

Maximum Output :2.4HP@1.76KW

Requires: Gasoline, 2-cycle oil, ignition battery & propeller

speed rang : 1500-15000rpm

Gasoline-Version : Pre-mixed Fuel, 25-40 (Gasoline):1 , Recommend:30:1
(90% high octane unleaded gasoline, Import gas into carbon fiber installations valves)

Lubrication Oil : 2 cycle engine oil

Propeller : 15X6 9000rpm (Standard Two leafs prop)

Suggested Propellers: 13X6,14X6,13X8,15X8,15X6

Suggested Break-in Prop: 15X8

Sparking plug: M8 1/4-32 Type

Cooling System : Air Cooled

Item	Description	Accessory Number
1.	CYLINDER	F3
2.	CRANKSHAFTACCESSORY	F20+F10
3.	CRANKCASE SET	F22+F16
4.	PISTON ACCESSORY	F8+F6+F11+F9+F7+F5
5.	PROP HUB ACCESSORY	F26+F25+F24
6.	BEARINGS	F23+F21
7.	IGNITION SET	S4
8.	WRIST PIN BEARING	F7
9.	REEDVALVE&INSULATOR	F14+F17+F18
10.	CARBURETOR	F12
11.	SPARK PLUG	S1
12.	MUFFLER	F1
13.	GASKET SET	F2+F4+F19+F15+F13
14.	SCREW SET	T1