

20cc RE

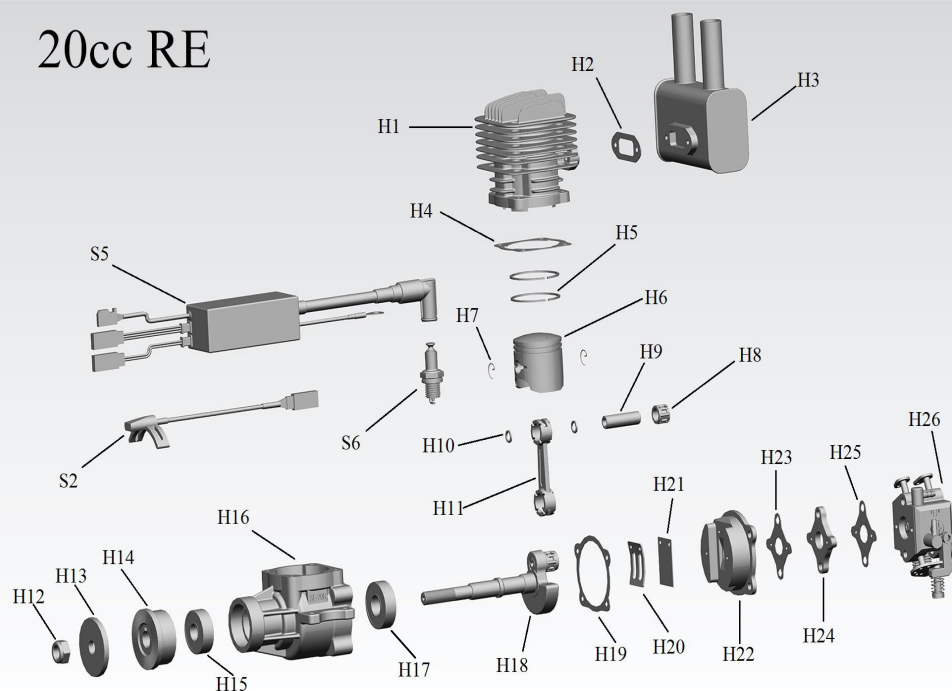

Ivan Michálek-IMI HOBBY CENTRUM

Stinger 20cc RE

Parameter:

Type : 2 cycle piston valve type gasoline engine for airplane

Piston displacement Cylinder (cc) : 20cc (1.22 cu in)

Bore x Stroke (mm): 1.3 in(32mm) x 9.5 in (24 mm)

Carburetor : Walbro

Ignition : DC-CDI (Computer Controlled auto advance, electronic ignition system)

Power supply: 6-14V

Maximum Output :2.8HP@2.1KW

Requires: Gasoline, 2-cycle oil, ignition battery & propeller

speed rang : 1500-10800rpm

Gasoline-Version : Pre-mixed Fuel, 25-40 (Gasoline):1 , Recommend:30:1
(90% high octane unleaded gasoline, Import gas into carbon fiber installations valves)

Lubrication Oil : 2 cycle engine oil

Propeller : 16X6 9000rpm ,16X8 8100rpm(Standard Two leafs prop)

Suggested Propellers: 14X10,15X8,16X6,16X8,17X6

Suggested Break-in Prop: 16X8

Sparking plug: NGK-CM6 Type

Cooling System : Air Cooled

Item	Description	Accessory Number
1.	CYLINDER	H1
2.	CRANKSHAFTACCESSORY	H18+H11
3.	CRANKCASE SET	H16+H22
4.	PISTON ACCESSORY	H5+H6+H7+H10+H9+H8
5.	PROP HUB ACCESSORY	H12+H13+H14
6.	BEARINGS	H15+H17
7.	IGNITION SET	S5
8.	WRIST PIN BEARING	H8
9.	REEDVALVE&INSULATOR	H24+H21+H20
10.	CARBURETOR	H26
11.	SPARK PLUG	S6
12.	MUFFLER	H3
13.	GASKET SET	H2+H4+H25+H23+H19
14.	SCREW SET	T1